



MODEL NO.
P12192BA

INSTRUCTIONS D'INSTALLATION

Les appareils doivent être installés par un électricien qualifié. Vérifiez les normes et les codes du bâtiment de votre région. Pour réduire les risques d'électrocution lors de l'installation ou de l'entretien, coupez l'alimentation électrique.

INSTALLATION INSTRUCTIONS
Luminaires must be installed by a qualified electrician. Check with local and national codes for proper installation. To prevent electrical shock, disconnect electrical supply before installation or servicing.



CFL ou **A19**
13W or **40W**

AMPOULE REQUISE
REQUIRED BULB

P12192BA

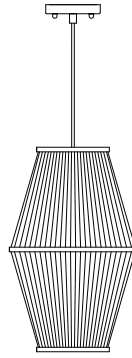

1

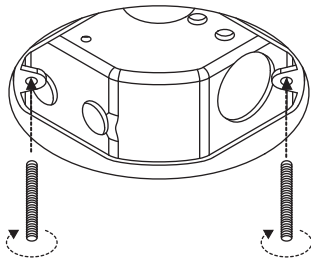

2

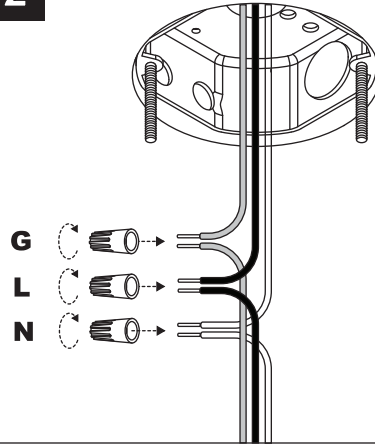

3

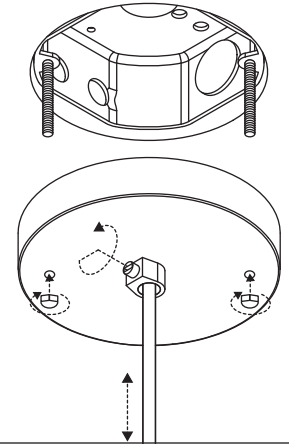

4

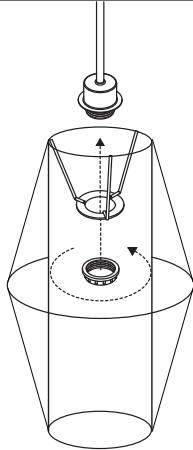

5

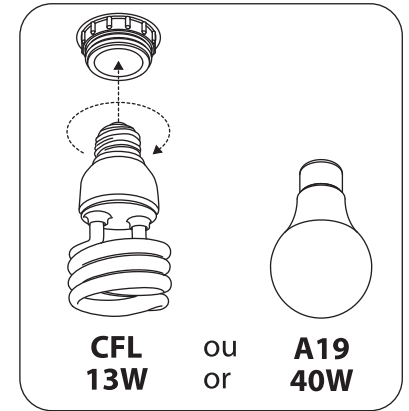
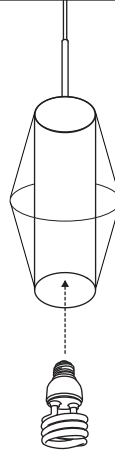

6

