

ASSEMBLE INSTRUCTION

5465T14DB-3

Ø14"*H26"

110V E12 3*40W MAX

- 1.PLEASE TAKE OFF THE PLASTIC SHEET FROM THE LAMP BODY.
- 2.PLEASE WEAR GLOVES WHEN INSTALLATION.

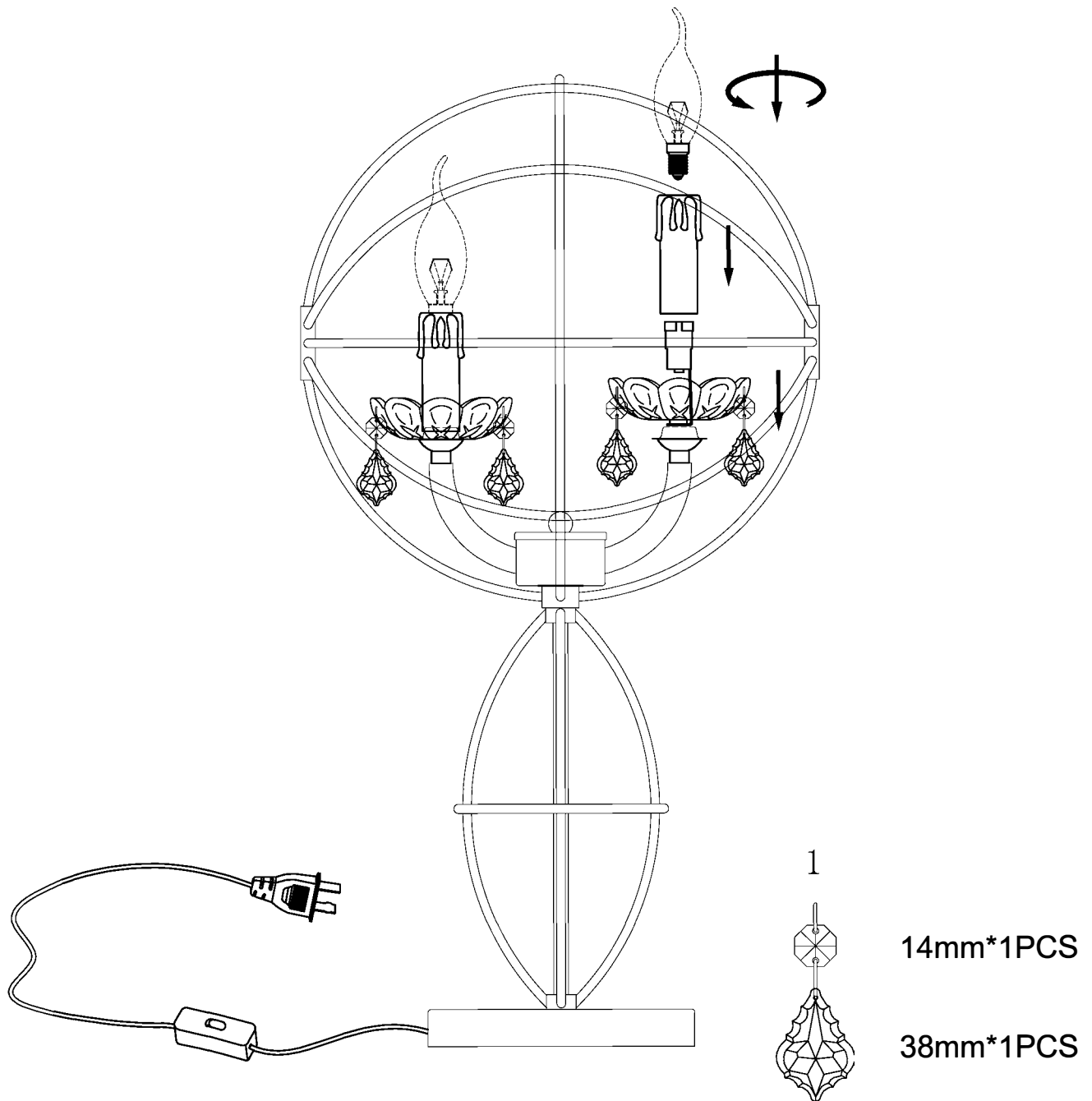

NO.	1		
Quantity	12		