

SPECIFICATION SHEET

SUBJECT

FLEX STREAM LINEAR STRIP

CUSTOMER PROJECT

Project: _____
 Type: _____
 Cat. No.: _____
 Qty: _____
 Date: _____
 EEL Rep: _____



solutions closer to nature

Telephone: 905 415 8878 Fax Number: 905 415 8872 Toll Free Telephone: 855 415 8878 Toll Free Fax: 855 415 8872

DESCRIPTION

The Flex Stream family delivers high quality, more uniform light, and sleek design versus fluorescent for a great range of applications. The LED Flex Stream is a true alternative to fluorescent strips and can save 30% energy over T8. Suitable for Damp Locations.



FLEX STREAM LINEAR STRIP

SPECIFICATION FEATURES

Construction

Die formed 22 gauge galvanized steel painted high gloss white finish

Electrical

Long Life LED System complete with electrical driver to deliver the optimal performance
LED's available in 4000K and optional 3500K and 5000K with a typical CRI: 80
Ambient temperature -40°C to 40°C
Electronic drivers are available in 120-277 and 347 Volt applications
L70 > 180,000h
L36000 = 93.3%

Driver and Module Access

Drivers can be accessed by removing the lens cover

Mounting

Surface mount or suspended mount with chain and v-hook (not included)

Note: Maximum mounting height with BRI810-B-D sensor is 3.25 m (10.7 ft).

Finish

22 gauge galvanized steel and high gloss enamel paint finish ensures maximum bonding and rust inhibition

Shielding

White LED Polycarbonate lens offers visual comfort

Compliance

Modules and Drivers are UL recognized components and indoor luminaires are cULus listed

Warranty

5 years

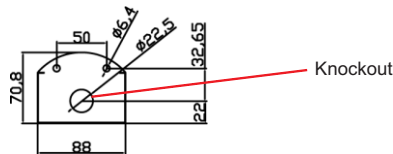
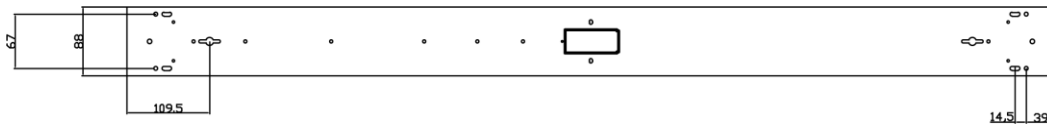

FS4-40LED04 (P)
FS4-40LED02 (P)
Dimensions
 mm | 1219(L) x 88(W) x 70(D)
 inch | 48(L) x 3.5(W) x 2.8(D)

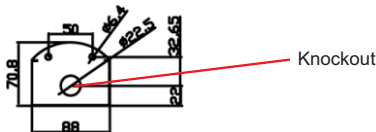
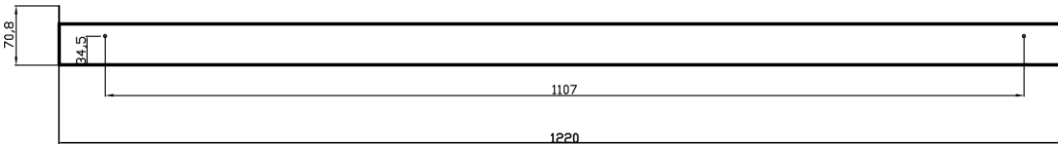

FS8-80LED08 (P)
FS8-54LED04 (P)
Dimensions
 mm | 2438(L) x 88(W) x 70(D)
 inch | 96(L) x 3.5(W) x 3.3(D)

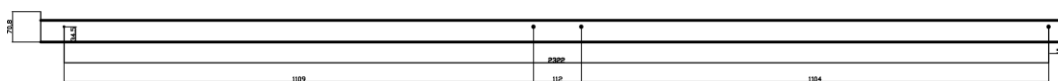



ORDERING CODE, ENERGY AND PERFORMANCE DATA

	Model No.	Delivered Lumens (lm)	Input Watts (W)	Voltage (V)	Colour Temp. (K)	Efficacy (lm/W)	Certification	Type
	FS4-40LED02 (P)	3201	29	120-277	4000K	110		Standard
	FS4-40LED02 (P)	3305	30	347	4000K	112		MTO
	FS4-40LED04 (P)	4679 4819	42 42	120-277 120-277	4000K 5000K	111 115		Standard MTO
	FS4-40LED04 (P)	4628 4767	42 42	347 347	4000K 5000K	110 114		Standard MTO
	FS8-54LED04 (P)	6553	57	120-277	4000K	114		Standard
	FS8-54LED04 (P)	6728	58	347	4000K	116		Standard
	FS8-80LED08 (P)	9135 10152	82 82	120-277 120-277	4000K 5000K	111 124		MTO MTO
	FS8-80LED08 (P)	9036 10043	82 82	347 347	4000K 5000K	110 122		MTO MTO

NOTE:

- Lumens are estimated
- DLC qualified may not apply to all versions within a model. Please check the DLC Qualified Products List at www.designlights.org to confirm which versions are qualified.





CONTROLS (OPTIONAL SENSORS & MOUNTING ACCESSORIES)

- 0-10V Dimming Driver (-D) | 120-277V or 347V
- BRI810-B-D | ON/OFF DIM Microwave Sensor 120-277
- YM2502 | High Bay Occupancy Sensor
- ULT - HC419S | On-Off Sensor Control | 120-277V[^]
- ULT - HC419V | Tri-level Dimming Control | 120-277V[^]
- FS-SBC | Sensor Bracket Cover

[^] to be installed externally with FS-SBC

EMERGENCY BACK-UP (OPTIONAL)

EMLEDS10155564 | LED Emergency Pack 120-277V

OPTIONAL ACCESSORIES

- FS-WG | 4ft Wire Guard
- FS-CV | 2-6 ft Chain 2-"V" Hooks

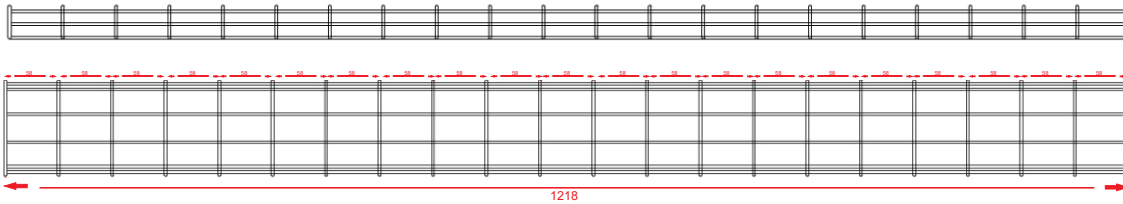

FS-WG

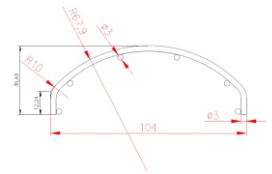

PHOTOMETRICS

Disclaimer: Photometric data result was obtained under white interior and linear prismatic lens condition. Disclaimer: Photometric data result was obtained under white interior and linear prismatic lens condition.

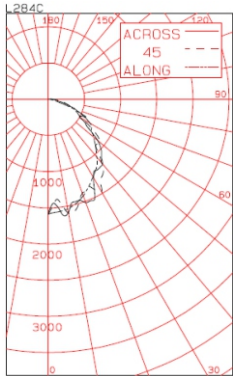

FS4-40LED04-120M (P) Candlepower
 S/MH = 1.2
 SC = 1.2
 Lumens: 4259
 Input Watts: 36.87
 Efficacy: 115.5 lm/W
 Test Report: L284C

ANGLE	ALONG	22.5	45	67.5	ACROSS
0	1586	1586	1586	1586	1586
5	1563	1470	1387	1456	1491
15	1490	1460	1549	1416	1464
25	1326	1547	1330	1461	1524
35	1160	1176	1297	1158	1188
45	930	1016	924	1050	1042
55	726	871	775	705	654
65	525	446	443	452	573
75	129	199	256	272	274
85	8	70	128	89	82
90	0	29	66	43	33
95	0	11	36	23	19
105	0	0	4	7	8
115	0	0	0	1	1

Zonal Lumen Summary

ZONE	LUMENS	% LAMP	% LUMINAIRE
0-30	1232	28.94	28.94
0-40	1988	46.70	46.70
0-60	3426	80.44	80.44
0-90	4231	99.35	99.35
40-90	2242	52.65	52.65
60-90	805	18.90	18.90
90-180	27	.65	.65
0-180	4259	100.00	100.00

Coefficient of Utilization
 Effective floor cavity reflectance = 20%

CC WALL	70	80	70	50	30	10	0
RCR	70	50	30	10	50	30	10
0	1.191	1.191	1.191	1.161	1.111	1.111	1.061
1	1.101	0.51	0.1	0.98	0.071	0.03	0.99
2	1.01	0.93	0.87	0.82	0.98	0.91	0.86
3	0.92	0.83	0.75	0.70	0.90	0.81	0.74
4	0.86	0.75	0.67	0.60	0.83	0.73	0.66
5	0.79	0.67	0.58	0.52	0.77	0.66	0.58
6	0.73	0.60	0.52	0.46	0.71	0.59	0.51
7	0.67	0.54	0.46	0.40	0.65	0.53	0.45
8	0.62	0.49	0.41	0.35	0.61	0.48	0.40
9	0.58	0.45	0.36	0.31	0.56	0.44	0.36
10	0.53	0.41	0.33	0.28	0.52	0.40	0.33

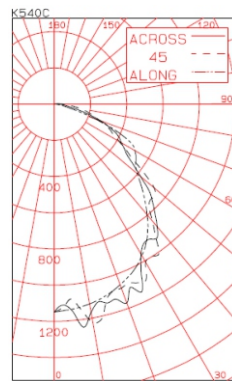

FS4-40LED02-120M (P) Candlepower
 S/MH = 1.2
 SC = 1.2
 Lumens: 3201
 Input Watts: 29.05
 Efficacy: 110.2 lm/W
 Test Report: K540C

ANGLE	ALONG	22.5	45	67.5	ACROSS
0	1148	1148	1148	1148	1148
5	1137	1117	1080	1123	1147
15	1096	1147	1117	1116	1137
25	1023	1145	1090	1092	1144
35	894	892	1007	887	912
45	694	822	749	772	769
55	551	591	528	502	491
65	423	290	343	362	372
75	91	174	205	189	161
85	6	55	86	55	45
90	0	30	45	27	23
95	0	12	21	15	15
105	0	0	3	5	3
115	0	0	0	1	1

Zonal Lumen Summary

ZONE	LUMENS	% LAMP	% LUMINAIRE
0-30	931	29.12	29.12
0-40	1506	47.07	47.07
0-60	2589	80.91	80.91
0-90	3181	99.40	99.40
40-90	1674	52.33	52.33
60-90	591	18.49	18.49
90-180	19	.60	.60
0-180	3201	100.00	100.00

Coefficient of Utilization
 Effective floor cavity reflectance = 20%

CC WALL	70	80	70	50	30	10	0
RCR	70	50	30	10	50	30	10
0	1.191	1.191	1.191	1.161	1.111	1.111	1.061
1	1.101	0.51	0.1	0.98	0.071	0.031	0.96
2	1.01	0.94	0.88	0.82	0.99	0.92	0.86
3	0.93	0.83	0.76	0.70	0.90	0.82	0.75
4	0.86	0.75	0.67	0.61	0.84	0.74	0.66
5	0.79	0.67	0.59	0.53	0.77	0.66	0.58
6	0.73	0.60	0.52	0.46	0.71	0.59	0.51
7	0.67	0.54	0.46	0.40	0.66	0.53	0.45
8	0.62	0.49	0.41	0.35	0.61	0.48	0.40
9	0.58	0.45	0.37	0.31	0.56	0.44	0.36
10	0.54	0.41	0.33	0.28	0.53	0.40	0.33

