



BOX Flood Light

FEATURES

- Built in 7-Pin NEMA photocell receptacle
- Includes shorting cap
- PowerSet feature allows for multiple “set and forget” lumen stops in each fixture

CERTIFICATIONS

- UL Listed for wet locations
- IP65 Rated
- DesignLights Consortium® Premium Qualified - meets the requirements for the highest DLC qualification for efficacy and lumen maintenance

PERFORMANCE

- Rated lifetime:
L70: >50,000 hours
- PowerSet:
150/100/80/50W; 21,000/15,300/12,500/8,200 lm (120V); 21,000/15,450/12,600/8,250 lm (277V)
300/240/200/150W; 41,300/35,500/29,500/22,900 lm (120V);
41,600/35,400/29,600/23,000 lm (277V)
- 5000K CCT
- CRI: >70

ELECTRICAL

- Input voltage: 120-277V, 277-480V
- 0-10V dimming
- Power Factor: >0.9
- THD: <20%

THERMAL

- -40°F to 122°F (-40°C to 50°C) operating temperature

CONSTRUCTION

- Die-cast aluminum heat sink for low weight and thermal performance
- UV resistant polycarbonate optical lens
- Durable powder coating for corrosion resistance
- Stainless steel hardware

WARRANTY

- 5 year limited warranty. Additional warranty options available. Contact EiKO for details

project name	type
catalog number	voltage
approved by	date



150W



300W

APPLICATIONS

- Parking Areas
- Automotive Dealerships
- Campuses
- Airports
- Area security lighting
- Building facades
- Signs
- Entryways

CONFIGURATOR

MODEL	LUMEN PACKAGE	CCT/CRI	VOLTAGE	DIMMING	FINISH
BOX1 : Flood Light	PS150 - 150/100/80/50W; 21,000/15,300/12,500/8,200 lm	750 - 70 CRI; 5000K	U - 120-277V	D - 0-10V Dimming	BZ - Bronze
	PS150 - 150/100/80/50W; 21,000/15,450/12,600/8,250 lm		V - 277-480V		
BOX2 : Flood Light	PS300 - 300/240/200/150W; 41,300/35,500/29,500/22,900 lm		U - 120-277V		
	PS300 - 300/240/200/150W; 41,600/35,400/29,600/23,000 lm		V - 277-480V		



PERFORMANCE SUMMARY

ORDER CODE	ITEM #	WATTS	NOMINAL LUMENS	LPW	CCT	DIMMING	VOLTS	DLC PREMIUM
12123	BOX1/PS150/750/UD/BZ	150/100/80/50W	21,000/15,300/12,500/8,200	135	5000K	0-10V	120-277V	✓
12125	BOX1/PS150/750/VD/BZ	150/100/80/50W	21,000/15,450/12,600/8,250	135	5000K	0-10V	277-480V	✓
12124	BOX2/PS300/750/UD/BZ	300/240/200/150W	41,300/35,500/29,500/22,900	135	5000K	0-10V	120-277V	✓
12126	BOX2/PS300/750/VD/BZ	300/240/200/150W	41,600/35,400/29,600/23,000	135	5000K	0-10V	277-480V	✓

ACCESSORIES

ORDER CODE	ITEM #	DESCRIPTION
12127	BOX/SFACC	Box Slipfitter Accessory
09966	PC1-4036-U	Photocell, Flush Mount, 120-277V
09967	PC1-4136-U	Photocell, Stem Mount, Side Lens, 120-277V
09968	PC1-4236-U	Photocell, Stem Swivel Mount, Side Lens, 120-277V
09969	PC1-4736-U	Photocell, Stem Swivel Mount, Top Lens, 120-277V

PRODUCT DIMENSIONS

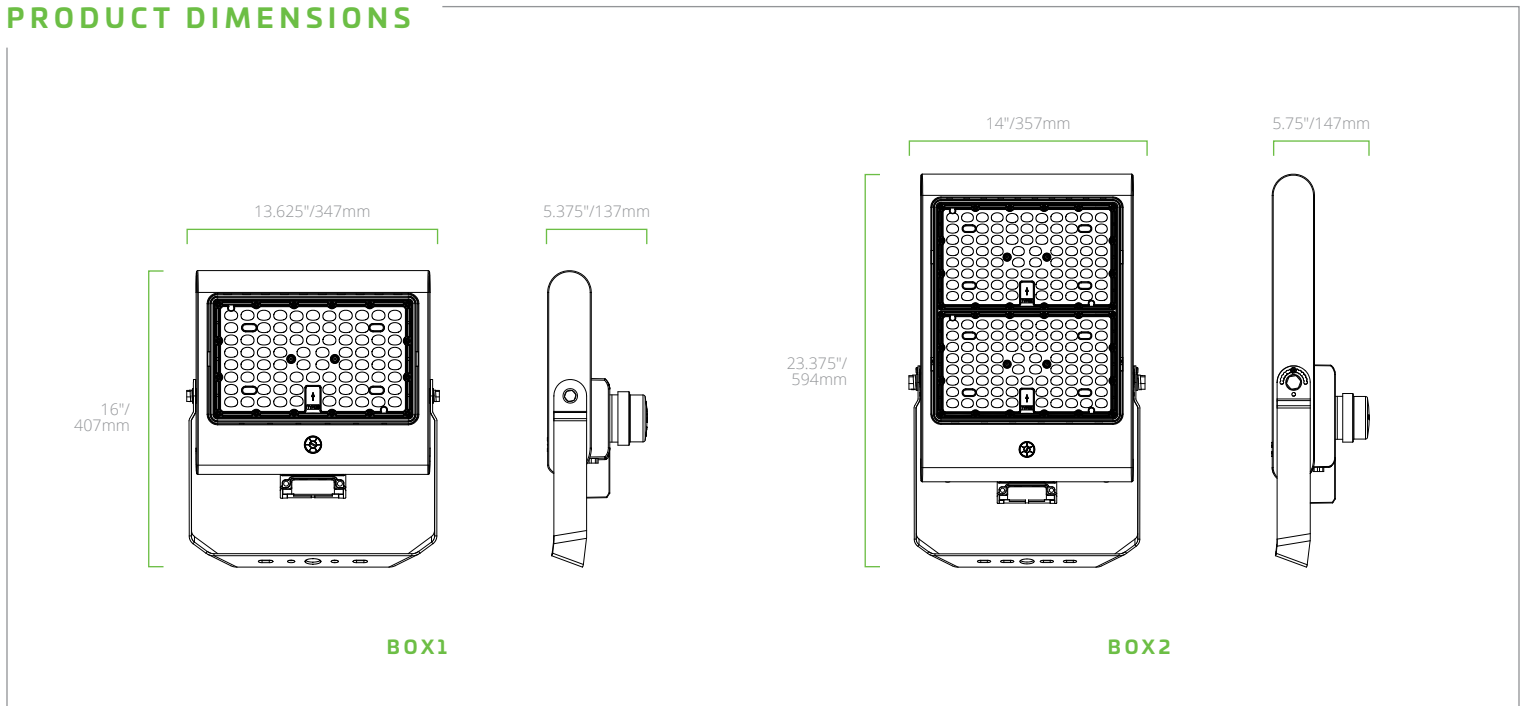

DISTRIBUTION

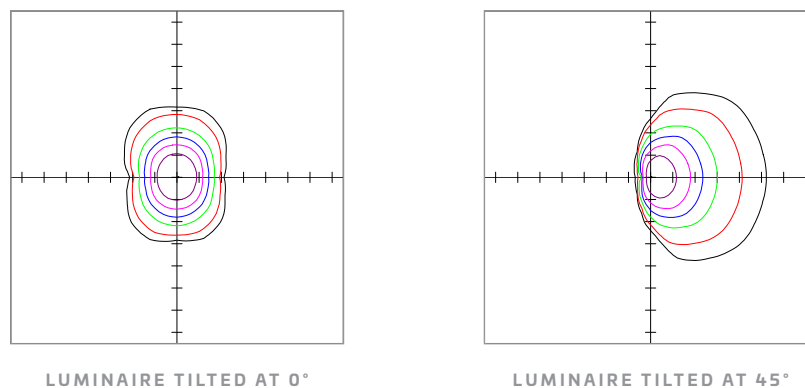

Distances are in units of mounting height (20').