



MaxLite® LED Vaporproof Jelly Jar

General Safety Information

- To reduce the risk of death, personal injury or property damage from fire, electric shock, falling parts, cuts/abrasions, and other hazards read all warnings and instructions included with and on the fixture box and all fixture labels.
- Before installing, servicing, or performing routine maintenance upon this equipment, follow these general precautions.
- Commercial installation, service and maintenance of luminaires should be performed by a qualified licensed electrician.
- For Residential installation: If you are unsure about the installation or maintenance of the luminaires, consult a qualified licensed electrician and check your local electrical code.
- **DO NOT INSTALL DAMAGED PRODUCT!**
- This fixture is intended to be connected to a properly installed and grounded UL listed junction box.

WARNING:

RISK OF ELECTRICAL SHOCK

- Turn off electrical power at fuse or circuit breaker box before wiring fixture to the power supply.
- Turn off the power when you perform any maintenance.
- Verify that supply voltage is correct by comparing it with the luminaire label information.
- Make all electrical and grounded connections in accordance with the National Electrical Code and any applicable local code requirements.
- All wiring connections should be capped with UL approved wire connectors.

CAUTION:

RISK OF INJURY

- Wear gloves and safety glasses at all times when removing luminaire from carton, installing, servicing or performing maintenance.
- Avoid direct eye exposure to the light source while it is on.
- Account for small parts and destroy packing material, as these may be hazardous to children.

CAUTION:

RISK OF FIRE

- Keep combustible and other materials that can burn away from luminaire and lamp/lens
- MIN 75°C SUPPLY CONDUCTORS.

Operating Temperature: -40°F to 104°F

Models:

JJ Series



Picture is for illustration purposes only. Your model may vary.



MaxLite® LED Vaporproof Jelly Jar

General Wiring Diagram

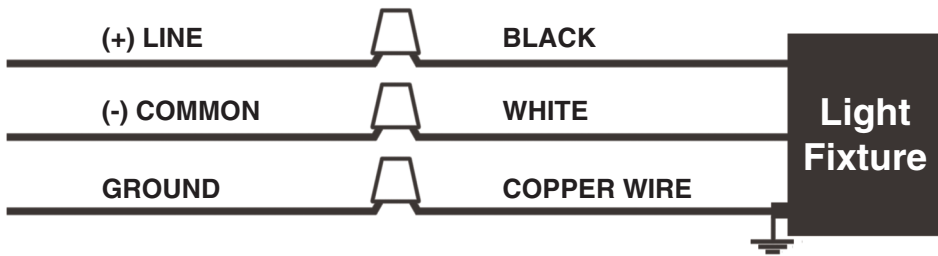

CAUTION: Turn off electrical power at fuse or circuit breaker box before wiring fixture to the power supply.

Connecting panels to AC source supply:
All units must be individually connected to the AC supply.

- Black = Line
- White = Neutral
- Copper Wire = Ground

Installation Instructions

Ceiling Mount:

Lighting Fixture must be located on ceiling and not be recessed and cannot be mounted upside down in wet locations.

1. Turn off power to branch circuit.
2. Remove the heatsink portion of the base junction box by removing the two (2) 2 ½" long flat head screws.
Note: the rubber gasket will have to be removed in order to remove the screws. Make sure that all components are set aside for later use (see **Fig. 1**).
3. Remove knock-out plug in the back of the junction box and pull the power supply leads into the junction box.
4. Secure the round base junction box to the ceiling with screws (see **Fig. 2**).
5. Apply a weatherproof silicone sealant between the ceiling and base junction box to ensure a waterproof seal.
6. Make wiring connections according to the wiring diagram. Ensure that any loose wiring connections are secured safely inside the junction box.
7. Realign the heatsink, flat head screws, gasket, base junction box and reassemble the fixture.
8. Loosen the set screw on the wire guard, Thread the glass globe and metal wire guard into heatsink. Tighten the set screw.
9. Restore power to the branch circuit.

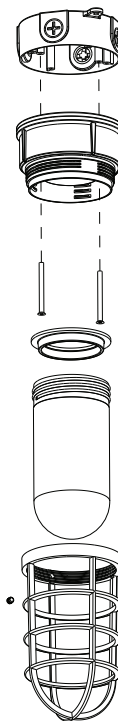

Fig. 1

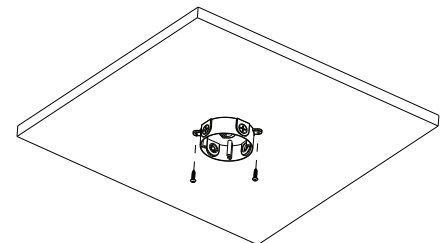

Fig. 2



MaxLite® LED Vaporproof Jelly Jar

Installation Instructions

Wall Mount:

Lighting Fixture must be located on Wall and not be recessed and cannot be mounted upside down in wet locations.

1. Turn off power to the branch circuit.
2. Remove the heatsink portion of the base junction box by removing the four (4) 3/4" long socket head screws. Make sure that all components are set aside for later use (see Fig. 3).
3. Remove knock-out plug in the back of the junction box and pull the power supply leads into the junction box.
4. Secure the round base junction box to the wall with screws (see Fig. 4).
5. Apply a weatherproof silicone sealant between the wall and base junction box to ensure a waterproof seal.
6. Make wiring connections according to the wiring diagram. Ensure that any loose wiring connections are secured safely inside the junction box.
7. Realign the heatsink and base junction box and reassemble with the four (4) socket head screws.
8. Loosen the set screw on the wire guard, Thread the glass globe and metal wire guard into heatsink. Tighten the set screw.
9. Restore power to the branch circuit.

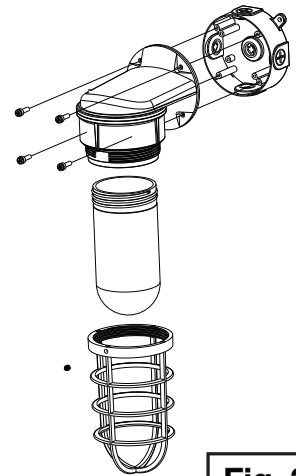

Fig. 3

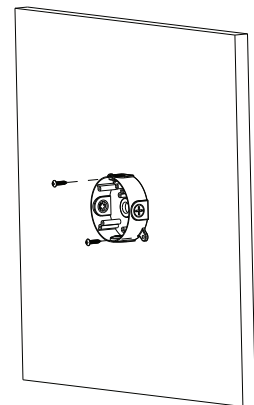

Fig. 4

Short Globe Accessory:

NOTE: Disregard the metal wire guard and long glass globe included with the fixture. These can be discarded when using the short globe. The short globe can be used with either the ceiling mount or wall mount models.

1. Once the fixture is wired and secured according to the instructions listed above, thread the short globe onto the heatsink. This applies to both ceiling and wall mounted fixtures (see Fig. 5).

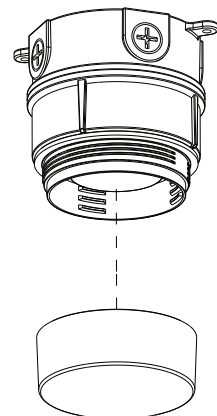

Fig. 5



MaxLite® LED Vaporproof Jelly Jar

Warranty Information

MaxLite Inc. warrants its products for a minimum period of **FIVE (5)** years from the date of original purchase from MaxLite or its authorized distributor/dealer (the "Warranty Period"), as follows: If a Product fails to operate during the Warranty Period as a result of defects in materials or workmanship, MaxLite will, at its option, repair it, replace it with the same or like Product.

Please refer to Maxlite's website (at <http://maxlite.com/resources/warranties>) for the complete terms and conditions of our warranty.

Limitation of Liability

THE FOREGOING WARRANTY IS EXCLUSIVE, AND IS THE SOLE REMEDY FOR ANY AND ALL CLAIMS, WHETHER IN CONTRACT, IN TORT OR OTHERWISE ARISING FROM THE FAILURE OF PRODUCT AND IS IN LIEU OF ALL OTHER WARRANTIES, EXPRESS OR IMPLIED, INCLUDING ALL WARRANTIES OF MERCHANTABILITY OR FITNESS FOR A PARTICULAR PURPOSE, WHICH WARRANTIES ARE HEREBY EXPRESSLY DISCLAIMED TO THE EXTENT PERMITTED BY LAW AND, IN ANY EVENT, SHALL BE LIMITED TO THE WARRANTY PERIOD SPECIFIED ABOVE. THE LIABILITY OF MAXLITE SHALL BE LIMITED TO THE TERMS OF THE EXPRESS WARRANTY SET FORTH HEREIN. IN NO EVENT WILL MAXLITE BE LIABLE FOR ANY SPECIAL, INCIDENTAL OR CONSEQUENTIAL DAMAGES INCLUDING, WITHOUT LIMITATION, DAMAGES RESULTING FROM LOSS OF USE, PROFITS, BUSINESS OR GOODWILL, LABOR COSTS, REMOVAL OR INSTALLATION COSTS, DECREASE IN THE LIGHT OUTPUT OF THE LAMP, AND/OR DETERIORATION IN THE LAMP'S PERFORMANCE, WHETHER OR NOT MAXLITE HAS BEEN ADVISED OF THE POSSIBILITY THEREOF. UNDER NO CIRCUMSTANCES SHALL MAXLITE'S ENTIRE LIABILITY FOR A DEFECTIVE PRODUCT EXCEED THE PURCHASE PRICE OF THAT PRODUCT. WARRANTY SERVICES PROVIDED UNDER THESE TERMS AND CONDITIONS DO NOT ENSURE THE UNINTERRUPTED OPERATION OF PRODUCTS; MAXLITE SHALL NOT BE LIABLE FOR DAMAGES CAUSED BY ANY DELAYS INVOLVING WARRANTY SERVICE.

This Limited Warranty gives you specific legal rights and you may also have other rights that may vary from state to state. Because some states or jurisdictions do not allow the exclusion or limitation of liability for consequential or incidental damages, this limitation may not apply to you.