

NTLE-207

Versa Gimbal Ring w/ Dimmable Electronic Transformer

Lamp: 3W-50W MR16

Type

Project

Catalog No.

Notes

PRODUCT DESCRIPTION

Low Voltage MR16 adjustable gimbal ring fixture. MR16 lamp clips directly into the adjustable gimbal ring with integral transformer/driver. A steel "L" bracket holds the gimbal ring in place and allows for full lateral aiming adjustment. Tightening knob assures secure lock on angle position.

FEATURES

- Compatible with Electronic or Halogen MR16 lamps
- Lightweight, strong steel construction
- Heat resistant Teflon coated wire lead
- Low profile gimbal ring with minimum profile
- Adjustable "L" bracket for precision aiming
- One or two circuit track capable

CONSTRUCTION

Contact Head Assembly: Three .030 stainless steel contacts mounted in high heat rated plastic housing.

Gimbal Ring: .030 Baked enamel finished steel ring. High-tension stainless steel spring secures MR16 light source.

Wiring: Teflon coated wire lead connects socket and housing to electrical contact head. Teflon coating is durable and resists heat degradation from lamp and housing radiation

ELECTRICAL

Voltage: 120V input / 12V output

Transformer: Electronic

Socket: GU5.3

Lamp: 3W-50W MR16 (Halogen or LED)

Dimming: ELV

ONE/TWO CIRCUIT CONVERSION

Positive contact (opposite neutral and ground contacts) is preset to "down" position at factory but may be raised to the higher position to install onto the second circuit of Nora Lighting NT-2300 series two-circuit track.

OPTIONAL ACCESSORIES

NM-100B/MR16: Blue Lens/Filter

NM-100C/MR16: Clear Lens/Filter

NM-100F/MR16: Frosted Lens/Filter

NM-100G/MR16: Green Lens/Filter

NM-100L/MR16: Linear Lens/Filter

NM-100R/MR16: Red Lens/Filter

NM-100S/MR16: Spread Lens/Filter

NM-100Y/MR16: Yellow Lens/Filter

LABELS AND LISTINGS

cULus Listed



PRODUCT IMAGES AND DIMENSIONS

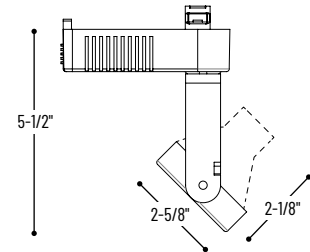

Versa Gimbal Ring with Dimmable Electronic Transformer

Catalog No.	Finish
NTLE-207	B = Black
	BZ = Bronze
	W = White

Optional Accessories

Catalog No.
NM-100B/MR16: Blue Lens/Filter
NM-100C/MR16: Clear Lens/Filter
NM-100F/MR16: Frosted Lens/Filter
NM-100G/MR16: Green Lens/Filter
NM-100L/MR16: Linear Lens/Filter
NM-100R/MR16: Red Lens/Filter
NM-100S/MR16: Spread Lens/Filter
NM-100Y/MR16: Yellow Lens/Filter

Example: **NTLE-207B** = Versa Gimbal Ring, Black Finish