

LED Barn Light



Sensor



Pre-Set :

Brightness: 100%
Turn on: 30 lux
Turn off: 150 lux
Delay: 5s
Sensitivity: 100%

Technical Specifications

Model No.:	TS-BL0280-80W-H-MV-TCP(PT)
Watt Selectable	40W/60W/80W
Voltage	120-347V
Dimming	0-10 V
CCT Selectable	3500K/4000K/5000K
Lumens	4800LM-9600LM
Dimensions	14.2"x9.47"x4.84"

Features

0-10V Dimming
5 years warranty

Electrical

Input voltage: 120-347VAC
Power factor: >0.9
THD: <20%

Performance

Rated lifetime L70 : 50/000 Hours
CRI> 80

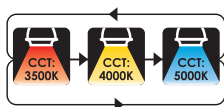

Installation

Wall Mounting Installation

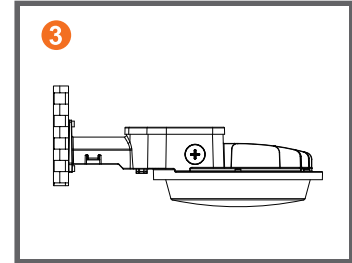
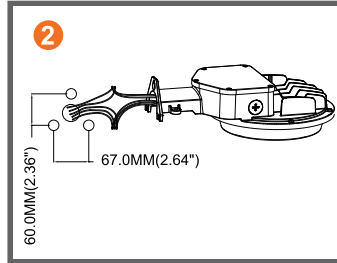
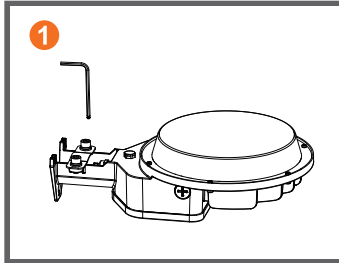

Arm Mounting Installation

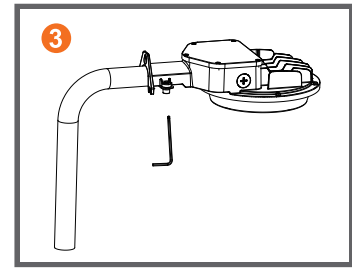
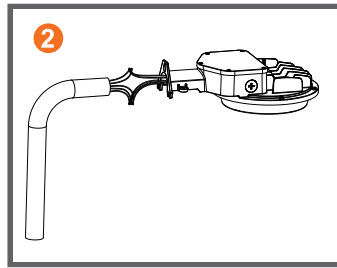
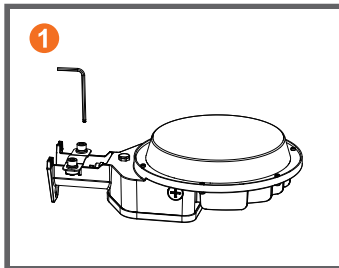

How to disable the sensor

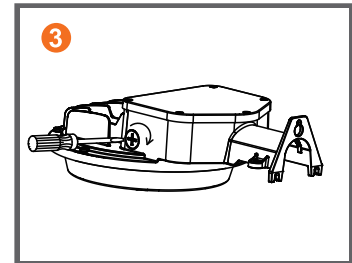
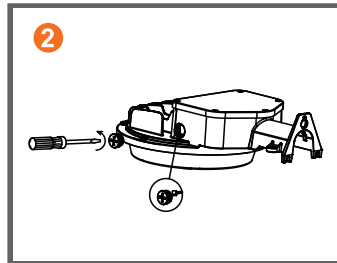
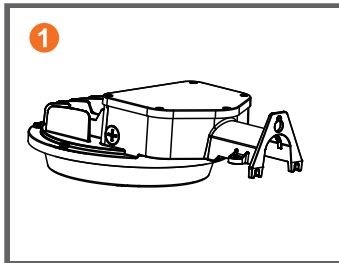

Dimensions

Models	L	W	H
TS-BL0280-80W-H-MV-TCP(PT)	14.22"	9.47"	4.84"

CCT
Switch

POWER
Switch

Multi Voltage
120-347V

Dimmable

IP65

LIGHT SENSOR

CCT: 3500K → CCT: 4000K → CCT: 5000K

ETL LISTED
Intertek

5 Years

